





AS 1920.4: "Swimming Pool Safety - Safety Barriers" (AS). Any barrier required under the provisions of Section 22 of the Act

Should the barrier incorporate a glazed fence or

shall also comply with the relevant design requirements of AS 1920.4 and Australian Standard 1288 - "Glass in Buildings".

This plan document is for the proposed water recirculation system of a swimming pool with a maximum depth of water more than 300 mm, if it complies with AS 1920.4: "Swimming Pool Safety - Safety Barriers" (AS).
Approved Construction F2022/1

Issued By First Building

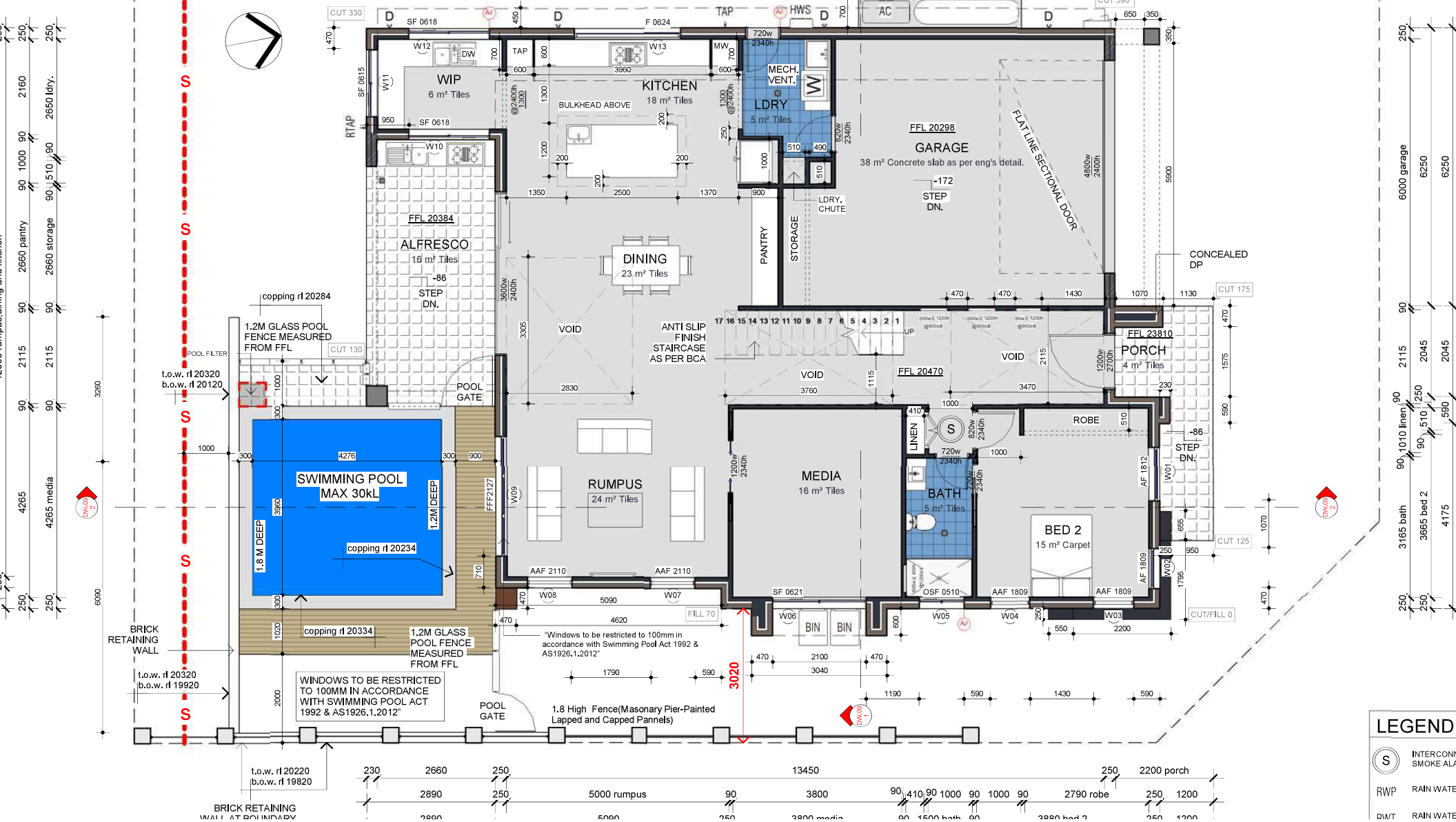

LEGEND	
(S)	INTERCONFLUENT SMOKE ALARM
RWP	RAIN WATER PUMP
RMIT	RAIN WATER METER



WINDOWS TO BE RESTRICTED TO 100MM IN ACCORDANCE WITH SWIMMING POOL ACT 1992 & AS1926.1.2012"